

ALCA

ALCA presents our
annual Turkey Trot
Saturday Oct 3, 2020
One Lure Coursing
Field Trial

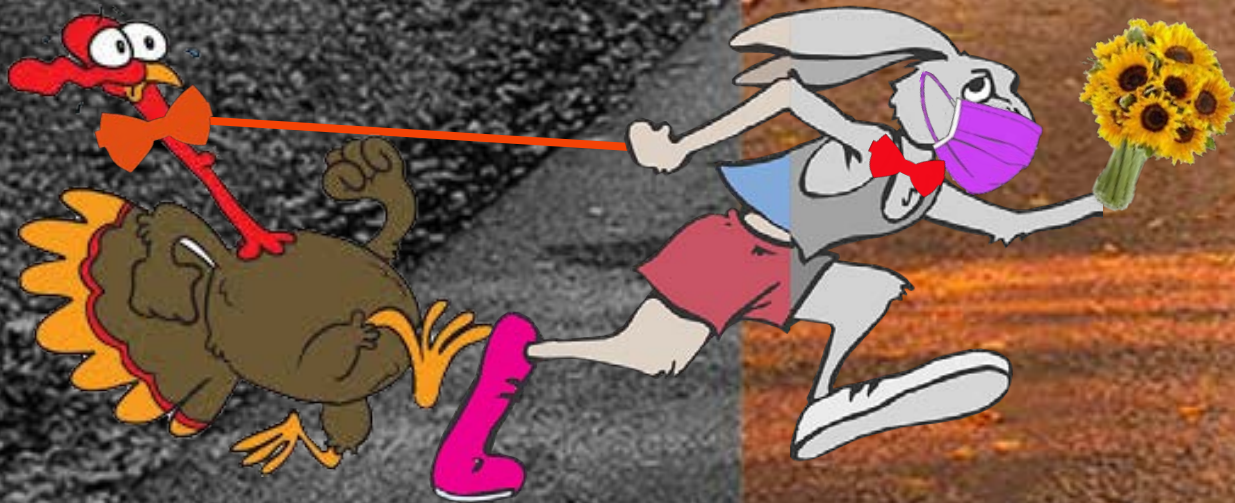

COVID-19 RULES AND PROCEDURES

The Alberta Lure Coursing Association is excited about taking on the challenge of holding CKC Lure Trial during this 2020 pandemic. We are absolutely committed to offering you a safe event and will follow Alberta Government guidelines regarding gathering limits, physical distancing, temperature testing and the wearing of face masks.

IMPORTANT: Please read and agree to all rules and guidelines regarding this event. By submitting entries to this Lure Trial you are declaring that you agree to the following strictly enforced rules and regulations. Please do not enter if you have personal or political reasons for not respecting what we must do to abide by the Alberta Government Covid-19 protocol to keep us all safe.

PRE-SCREENING: All exhibitors, volunteers, ALCA members, and judges will be subject to a pre-screening survey and temperature check using a non-contact forehead thermometer at check-in before being allowed on the grounds. The survey is verbal in nature and we will NOT collect or record any personal information. We reserve the right to deny access to anyone without proof of entry of an exhibit. All exhibitors will be required to check in at the gate and proof of entry may be required to enter – please print and bring your receipts!

PARKING & EXHIBITOR BENCHING: Parking will be designated in accordance with social distancing guidelines and will be assigned as you arrive. Please inform the Field Trial Secretary by Closing Date if you have mobility issues that require special parking arrangements. Exhibitor benching will be at the vehicle parking site. Pop-Up tents may be set up in your space if needed. Because of Covid-19 Safety Rules - Exhibitors are requested to be self-sufficient while on the grounds. We will not be offering a concession; however, we will be having a catered Turkey dinner at lunch on Saturday. Caterers will serve food on disposable plates and will meet Covid requirements. Due to Covid we will not be having a Pot Luck. Seating will be 'bring your own' and social distancing will be required.

MASKS: This is an outdoor event. Masks are required 100% of the time in the Field Trial Secretary's area, at the line when your dog is coursing and in the Turkey Dinner service line. Masks are strongly encouraged at all other times **REGARDLESS** if you can or cannot social distance. We request that you bring your own mask, however, masks are available at the venue.

SOCIAL DISTANCING: Social Distancing must be diligently practiced, and all exhibitors will follow the direction of ALCA volunteers, Field Trial Secretary, and Field Trial Chair at all times. Wins are exciting but please ... no hugs or high-5 celebrations outside your bubble!

ROLL CALL PROCEDURES: Social distancing & Mask protocols are mandatory. Hounds to be gaited to check for soundness and adequacy of equipment for Field Trial Committee without breaching the social distance guidelines. ALCA will provide tissues and designated waste receptacle so that owners can swab females to demonstrate that they are not in season.

HAND WASHING STATIONS: Hand washing stations and hand sanitizer will be available to exhibitors and volunteers throughout the grounds – USE THEM REGULARLY.

BE SELF SUFFICIENT: Please remember to bring personal face coverings, hand sanitizer, gloves, cleaning wipes, etc. for your own personal use.

VOLUNTEERING: Hosting this event in these times will require additional volunteers. We have designated breed running order so that everyone can take a shift volunteering to keep our venue safe and to ensure that Covid Protocols are maintained. We appreciate all volunteers – it takes a community to keep us all safe.

THERE WILL BE A ZERO TOLLERANCE POLICY ON COVID-19 VIOLATIONS, INCLUDING NOT WEARING A MASK OR NOT SOCIAL DISTANCING WHEN IT IS POSSIBLE. DEPENDING ON THE LEVEL OF THE VIOLATION, YOU MAY GET A FRIENDLY REMINDER OR YOU MAY BE ASKED TO PACK YOUR STUFF AND LEAVE IMMEDIATELY. ENTER THIS EVENT AT YOUR OWN RISK We ask all our Volunteers and Exhibitors to make their own health and safety a priority. **NO ONE** who is feeling ill, or showing signs of illness, or who has been exposed to someone who is ill should be attending this show or going out in public. Anyone with a probable case of illness shall utilize the on-line assessment tools and health link services to determine their risk and necessary precautions. **AGAIN - Please be DILIGENT – DO NOT** attend this event if (in the last 14 days before the show date):

- You have traveled outside of Canada
- You, your child or a cohort have had close unprotected contact with someone who is ill
- You, your child or cohort have been in close unprotected contact with someone who is being investigated, or confirmed to be a case of COVID-19
- **DO NOT ATTEND** if you are experiencing any of the following symptoms:
Fever, Difficulty Breathing, Persistent Cough, Sore Throat, Runny Nose

PLEASE NOTE: Exhibitor entry information can be used for contact tracing efforts upon request of the Alberta Government. Information about attendees will only be requested by AB Health if a potential exposure occurs on site. All Albertans must follow CMOH Order 05-2020, which establishes legal requirements for quarantine and isolation. • Anyone with symptoms of COVID-19; with a history of international travel in the last 14 days; or with close contact with a confirmed case of COVID-19 in the past 14 days must remain at home. **IMPORTANT FOR YOU TO KNOW** If there are changes to the Alberta Government or Strathcona County protocols and our show must be cancelled all entry fees will be refunded (less c/c service charges).

Official Premium List



ALBERTA LURE COURSING ASSOCIATION

Announces

ONE CKC LURE FIELD TRIAL – SATURDAY, OCTOBER 3, 2020
(Outdoors)

These Events Held Under the Rules of the Canadian Kennel Club

To Be Held At:
Bremner House

53452 Rge Rd 225, Sherwood Park, AB T8A 4V3
Co-Ordinates: Lat 53 deg, 36', 30.0" N, Long –113 deg, 13', 29.0" W

Mail ALL Entries To:
Miriam Woestenburg,
12927-78 St. Edmonton, AB, T5C 1G6
(780) 456-2866

E-mail: minidragon@shaw.ca

Secure on-line entry service now available at
www.dogshow.ca (VISA, Mastercard, American Express & Interac)



'Early Bird' Entry Closes: Wednesday September 30, 2020

Post Entry Closes:	Saturday	8:30 a.m. 10:00 am	Coursing Official Classes Puppy, Veteran
Roll Call:	Saturday	9.00 a.m. 11:00 a.m	Coursing Official Classes Puppy, Veteran

Due to Covid-19 Protocols we prefer that dogs be Pre-entered.

Rolling Inspection from arrival to Roll Call

******IF ENTERING ONLINE WE WILL HAVE WAIVERS AVAILABLE AT ROLL-CALL******

LURE TRIAL OFFICIAL CLASSES OFFERED

Open Stake - for all eligible hounds one year of age or older, including Field Champions. If there are multiple breeds with entries of three or less, upon agreement of all owners, they will be combined in a **Mixed Stake**.

LURE TRIAL UNOFFICIAL CLASSES OFFERED

Best In Field – to include all Best of Breed or Mixed Stake winners

Puppy – (6-9, 9-12, 12-18 months) - **Between Preliminary & Final Runs**– before or after Turkey Dinner depending on time.

Veteran – (eligible for dogs 7 years and older) **Between Preliminary & Final Runs**– before or after Turkey Dinner depending on time.

Kennel Stake

Breeder Stake

Club Stake

!! ALCA CATERED TURKEY DINNER ON THE FIELD !!
HIGH NOON
NOT A POTLUCK IN THESE COVID TIMES!!
\$15 Adult, \$8 Children

ENTRY FEES:

LURE FIELD TRIAL

Pre-entry, first hound (closes Sept 30)	\$22.00	includes CKC recording fees
Pre-entry, each additional hound same owner/co-owner	\$20.00	includes CKC recording fees
Post entry (after Sept 30)	\$35.00	includes CKC recording fees
TCN (Temporary Competition Number) Fee per event per dog	\$10.50	
PUPPY, VETERAN, KENNEL, BREEDER, CLUB	\$ 5.00	
POTLUCK	Adult	\$ 15.00
	Child – 12 & under	\$ 8.00

COURSING JUDGES:

Karen Douglass – Ponoka, AB Linda Smith – Edmonton, AB Lynda Webster – Edmonton, AB

JUDGING ASSIGNMENTS:

	Saturday Oct 3
Afghan Hound	KD & LS
Azawakh	KD & LS
Basenji	KD & LS
Borzoi	KD & LS
Deerhound (Scottish)	KD & LS
Greyhound	KD & LS
Ibizan Hound	KD & LS
Irish Wolfhound	KD & LS
Italian Greyhound	KD & LS
Pharaoh Hound	KD & LS
Rhodesian Ridgeback	KD & LS
Saluki	KD & LS
Whippet	KD & LW
Mixed Stakes	Any two depending on entry



TOLL FREE FAX: 1-877-99-ENTRY (36879)



A service charge of 10% will be assessed. This includes entries sent online, by fax or post using a credit card or Interac for payment.

ROLL CALL TIMES AND RUNNING ORDER

We are offering a Rolling inspection between the time you arrive and Roll Call.
Official Classes Post Entry closes at 8.30 a.m. Roll Call at 9:00 a.m
Puppy Stake & Veteran Stake Post Entry closes at 10:00 a.m Roll Call 11:00 a.m.

Breed running order will be posted at Roll Call.
Puppy Stakes and Veterans will be run after the Preliminary runs.
Best in Field - Open to all Breed and Mixed Stake winners.

PRIZES & AWARDS

OPEN:

Best Of Breed, First in Mixed Stake and Best in Field: Rosette & prize
Second to Next Best Qualifier: Rosette

Qualifying Score: Ribbon will be offered for each **qualifying score** earned by a hound which has not previously earned the Novice Courser Title. Please let the Field Trial Secretary know if your hound qualifies.

BEST PUPPY:

Highest score for a **Puppy in Field:** Rosette & prize
First to Next Best Qualifier in each age class: Ribbon

BEST VETERAN:

Highest score for a **Veteran in Field:** Rosette **2nd** to **NBQ:** Ribbon

NOVICE:

Highest Score for a Hound competing in its First Trial: Rosette
Scores adjusted for judges' averages.

KENNEL STAKE:

Rosette (scores adjusted for judges' averages)

BREEDER STAKE:

Rosette (scores adjusted for judges' averages)

CLUB STAKE:

Rosette (scores adjusted for judges' averages)

2020 AGGREGATE AWARD: **DUE TO THE COVID-19 PANDEMIC HIATUS THE ALCA AGGREGATE AWARD WILL NOT BE OFFERED FOR THE 2020 COURSING SEASON**

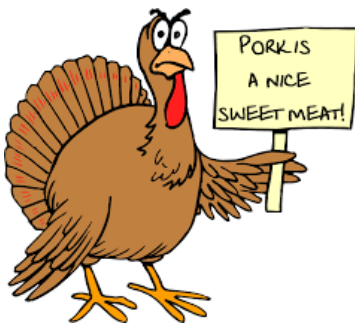

720 yards

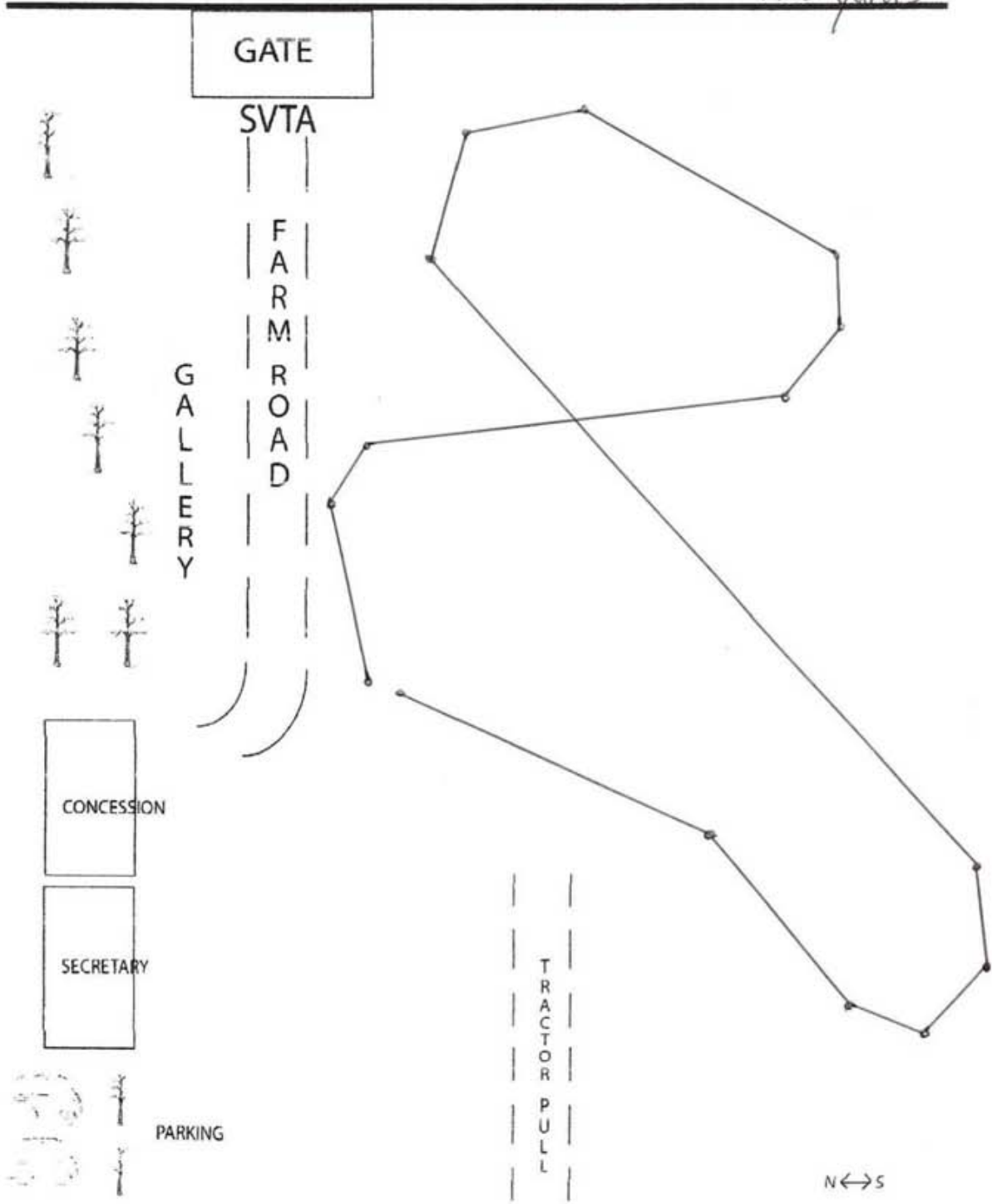

Happy Thanksgiving

Adults \$15 x _____

Kids \$8 x _____

Total \$ _____

Includes all the fixings
and desserts !!!

Welcome to the 8th annual
Turkey Trot Lure Coursing
Lunch!

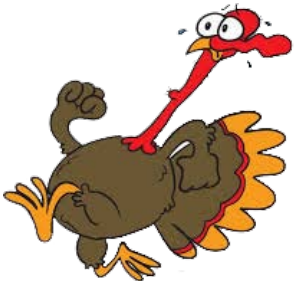

FIELD TRIAL COMMITTEE AND OFFICIALS		ALBERTA LURE COURSING ASSOCIATION 2020 EXECUTIVE	
Field Trial Chair	Ed Molloy	President	Bobbi Westman
Field Trial Committee:	Ivy Molloy Miriam Woestenburg Cindy Kremer Cheri Hunchak	Vice President	Brendan Molloy
Field Clerk	Nevidka Algu Ivy Molloy	Secretary	Cindy Kremer
Field Trial Secretary	Miriam Woestenburg	Treasurer	Ivy Molloy
Lure Operators	Cherie Hunchak Ed Molloy		
Hunt Master	Brendan Molloy Piet Woestenburg Nevidka Algu		
Paddock Master	Cindy Kremer		
COMPLAINTS COMMITTEE: Ivy Molloy, Miriam Woestenburg, Cherie Hunchak, Cindy Kremer			

ATTENTION:

It shall be the duty and obligation of the trial-giving club to see that a judge, club official, volunteer or any participant at an event held under these rules is not subject to indignities of any kind. The Field Trial Committee Chair shall promptly report to the CKC any infringement of this regulation, and the CKC shall have the authority to take such action as it deems fit on receipt of a report indicating that this has occurred.

CANADIAN KENNEL CLUB OFFICIALS:

THE CANADIAN KENNEL CLUB EXECUTIVE DIRECTOR

Mr. Lance Novak, 200 Ronson Drive, Suite 400, Etobicoke, ON, M9W 5Z9 (416) 675-5511

THE CANADIAN KENNEL CLUB DIRECTOR FOR ALBERTA

Sharon Derrick, 60 Riverview Cl SE, Calgary, AB, T2C 4C4, Tel: (403) 236-7280, sderrick@shaw.ca

ALBERTA LURE COURSING REPRESENTATIVE

Ed Molloy 169-52061 RR215 Sherwood Park, AB T8E 1B2

DIRECTIONS TO THE FIELD:

From South: Hwy 21 North to Township Road 534 (First road after Hwy 16 overpass)

Turn right (east) onto Twp Rd 534 and proceed to Range Road 225 (First cross road)

Turn left (north) onto Rge Rd 225. Field is 1 km north on left side of road. Entrance has SVTA in big letters over the gate

From West: Hwy 16 east to Range Road 225 (First road after Hwy 21, approx 2 km)

Turn left (north) on Rge Rd 225

Field is 4 km north of Hwy 16 on left side of road. Entrance has SVTA in big letters over the gate.

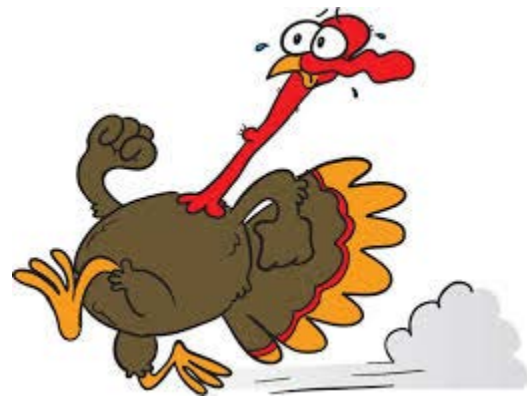

EQUIPMENT AND FIELD CONDITIONS:

The field is a mown hay field, flat on the west side, sloping towards the road.

An electric drag will be used.

A continuous loop may be used for the Puppy and Veteran stakes.

CONDITIONS AND INFORMATION:

- **Lunch will be a catered TURKEY DINNER. Sides and dessert will be supplied. WILL NOT BE A POTLUCK IN THESE COVID TIMES!**
- Rolling inspection – check in for inspection as you arrive, with your dog(s). Inspection ends ½ hour after entries close each day (roll call). It is your responsibility to take your dog for inspection prior to roll call.
- **Lure Coursing is a strenuous athletic pursuit that requires your dog to be in excellent condition. Your dog relies on you to ensure this**
- All hounds will be run in trios or braces, twice, unless excused, dismissed or disqualified.
- Hounds not present at roll call will be scratched, and their entry fee will NOT be refunded. No exceptions will be made.
- All handlers MUST use a slip lead when releasing their hounds.
- Hounds may wear muzzles and/or catch collars at the owner/agent's discretion.
- Bitches in season and lame hounds will be excused and will have their entry fee returned if notice is given to the secretary **prior** to roll call.
- The Chair may excuse any hound from competition for any reason deemed justifiable.
- A \$10.00 fine, payable to ALCA, will be levied for any hound loose on the field at any time between Roll Call and the completion of Best in Field.
- There is limited shade and no water available, so please come PREPARED.
- ALCA, its agents, members, representatives, volunteers, etc. assume no responsibility for any loss, damage or injury sustained by exhibitors, handlers, or to any of their dogs or property and further assume no responsibility for injury to children or spectators.
- All rights to televise, videotape, advertise, photograph, promote or otherwise exploit this event are vested in the club, or in persons to whom assignments of such rights have been made in writing by the club. All persons and animals attending these events grant the club the right to use their likeness and voice in any matter without further consent.

Camping: Limited overnight camping on the field. Please contact Ed Molloy to reserve your spot. 780 922-5218.

OFFICIAL VET

PulseVet 780-570-9999

<https://pulseveterinary.ca/#:~:text=Pulse%20Veterinary%20Specialists%20and%20Emergency%20is%20a%20brand,are%20conveniently%20located%20just%20off%20Anthony%20Henday%20Drive.>

**ALL RULES GOVERNING THESE EVENTS
ARE AVAILABLE ON LINE FROM THE CANADIAN KENNEL CLUB**

<https://www.ckc.ca/en/Files/Forms/Shows-Trials/Event-Rules-Regulations/Lure-Coursing-Field-Trial-Rules-and-Regulations.aspx>



Official Canadian Kennel Club Entry Form

Alberta Lure Coursing Association
Saturday, October 3, 2020
Turkey Trot



I Enclose \$ ___ for Entry Fees \$ ___ TCN \$ ___ Other \$ ___

PLEASE TYPE OR PRINT CLEARLY

Breed _____ Call Name _____ Sex _____

Regular Classes Open _____ Turkey Lunch _____	Unofficial Classes	
	Puppy 6-9 mos _____	Veteran _____
	Puppy 9-12 mos _____	Puppy 12-18 mos _____
	Breeder _____	Kennel _____ Club _____

Registered Name of Dog _____

Check one & enter Number here: _____ Is this dog's first trial? Y___ N___
If Yes, bring or attach Certification

CKC Reg. No.	Date of birth	Is this a puppy? Y___ N___
CKC ERN No.	D_____ M_____ Y_____	
CKC Misc. Cert. No.	Place of Birth: Canada ___ Elsewhere ___	Owner's CKC Membership No.
CKC PEN No.		
TCN (Temporary Competition No)		
Foreign No. & Country		

Breeder(s) _____

Sire _____

Dam _____

Reg'd Owner(s) _____

Owner's Address _____

City _____ Prov _____ Postal Code _____

Name of Owner's Agent (if any) at the Trial _____

Agent's Address _____

City _____ Prov _____ Postal Code _____

___ VISA ___ MASTERCARD ___ AMERICAN EXPRESS

CARD NO. _____ EXPIRY ____/____

CARDHOLDER NAME (PLEASE PRINT): _____

I CERTIFY that I am the registered owner(s) of the dog or that I am the authorized agent of the owner(s) whose name(s) I have entered above and accept full responsibility for all statements made in this entry. I CERTIFY that one of the owners has the CKC membership number listed above. In consideration of the acceptance of this entry, I (we) agree to be bound by the rules and regulations of the Canadian Kennel Club and by any additional rules and regulations appearing in the premium list.

Signature of Owner or Agent _____ Phone _____

Email _____



Alberta Lure Coursing Association - Accidental Waiver & Release of Liability Form

In consideration of the acceptance of this Alberta Lure Coursing Association (ALCA) membership and or individual practice/fun(s) runs, the holding of this event(s), official trials, and the opportunity to have the canine(s) run, I agree to hold the organizing committee, the organization which it represents, including its members, officers and directors, volunteers, owners of the premises upon which the event(s) is held and their employees, hold harmless from any claim for loss or injury which may be alleged to have been caused directly or indirectly to any person or thing by the act of this dog while in or upon the event premises, or grounds, or near any entrance thereto, and I personally assume all responsibility and liability for any such claim.

I further agree to hold the aforementioned parties harmless from any claim for loss of this dog by disappearance, theft, death, or otherwise, and from any claim for damage or injury, to be caused or alleged to be caused by negligence of the parties aforementioned, or by the negligence of any other person, or any other cause or causes.

I hereby assume the sole responsibility for and agree to indemnify the aforementioned parties hold harmless from any and all loss and expenses (including legal fees) by reason of the liability imposed by law upon any of the aforementioned parties for damage because of bodily injuries, including death at any time resulting there from sustained by any person or persons, including myself and my guest or on account of damage to property, arising out of or in consequence of my participation in this event, howsoever such injuries, death or damage to property may be caused or may have alleged to have been caused by negligence of the aforementioned parties or any of their employees or agents, or any other person.

I hereby consent to receive medical treatment, which may be deemed advisable in the event of injury, accident, and/or illness during this activity.

The Accident Waiver and Release of Liability Form shall be construed broadly to provide a release and waiver to the maximum extent permissible under applicable law.

Name: _____ Phone: _____ Email: _____

Name of Canine(s)

#1 _____ Any Canine Health Related Issues: _____
#2 _____ Any Canine Health Related Issues: _____
#3 _____ Any Canine Health Related Issues: _____

I certify that I have read this document and I fully understand its content. I am aware that this is a release of Liability and a contract and I sign it of my own free will.

Signature: _____ Date: _____

Signature of parent/guardian is required for children under 18 years _____

I understand while participating in this activity, I or my canine(s) may be photographed. I agree to allow my photo, video, or film likeness to be used for any legitimate purpose by the activity holders, producers, sponsors, organizers, and assigns. If unable to have your picture/video taken for any reason please notify our Field Chairman.

Signature: _____ Date: _____

Signature of parent/guardian is required for children under 18 years _____