

PREMIUM LIST

For Irish Wolfhounds Only



Irish Wolfhound Club of Canada
Presents an Irish Wolfhound only

LARGE GAZEHOUD RACING ASSOCIATION MEET

Sunday September 27, 2020

Roll Call 12:00 NOON

Entry Fees: \$20.00 per hound

No Gate Entries allowed due to COVID restrictions

Note: Masks will be required at the start and finish lines,
within 10 feet of the Secretary's table
and at all other times when physical distancing is not possible

FTE Entries: additional \$2.00 plus copy of Canadian or American registration

ENTRIES CLOSING DAY THURSDAY SEPT 24, 2020

RACE SECRETARY

Susan Prokopenkp
18043 Humber Station Rd,
Caledon East, ON L7E 3A8
416-200-0567

glenamadda@gmail.com

Race Meet Location:

Kincairn Farm
3874 Old Second Rd North
Elmvale (Springwater), Ontario L0L 1P0

IMPORTANT NOTICE: In order to run a race meet of this type, it is imperative that all owners pitch in to help. That means having a place to contain your Wolfhound when he is not running so that you can help with the other races. We'll need volunteers to walk hounds to the starting line and to line/foul judge.

IRISH WOLFHOUND CLUB OF CANADA

President.....Jocelyne Gagné
Vice-Presidents..... Guylaine Gagnon, Katy Albrecht , Fran Briscoe
Secretary:..... Kathie Upton
Treasurer..... Kathie Upton
Directors:..... Cindy Kremer, Suzan Humphreys, Harry Odenwald, Monique Seguin, Cindy Hewson
LGRA Delegate..... Susan Prokopenko

Race Committee Members: Susan Prokopenko, Celeste Atkinson, Donna Tomson, Lani Hopf, Harry Odenwald

WHAT IS LGRA?

LGRA is sprint racing for Gazeounds. The hounds run 200 yards straight after a lure consisting of a fur bag and squawker. Up to four hounds race a total of three times, called programs. Depending on the order of finish, they may attain national points towards a GRC (Gazehound Race Champion) title. Hounds will be hand slipped. More information can be found at www.lgra.org

Hounds need to be one year of age or older to be entered. They will also need to be registered with LGRA. This can be done the first time the hound is raced by including a photocopy of the hound's registration papers (either Canadian or American) with the entry. After registration, your hound will receive an LGRA number that will be used in entering future LGRA meets.

HOUNDS WILL NOT BE ALLOWED TO ENTER WITHOUT A COPY OF PROPER REGISTRATION AT THE TIME OF ENTRY. NO EXCEPTIONS WILL BE ALLOWED.

All hounds will run muzzled to prevent damage to the squawker. It is recommended that hounds be accustomed to a muzzle before the event. A limited supply of racing muzzles will be available for use so please bring your own if possible. Numbered racing blankets will also be available. Bitches in season are not allowed to compete.

Previous experience is not required. Time allowing, several practice runs will be held for new hounds.

Dogs five (5) years of age or older are considered Veterans for Straight racing.

Try it and see – your hound may surprise you!

ENTRY FEES

The entry fee for each hound is \$20 and the entry/email must be received by the Race Secretary by SEPT 24, 2020. First time entries must include an additional \$2 and a copy of registration certificate. Payments are to be made by eTransfer to glenamadda@gmail.com for Email entries.

IWCC RACE SECRETARY

Susan Prokopenkp
18043 Humber Station Rd,
Caledon East, ON L7E 3A8
416-200-0567
glenamadda@gmail.com

ALL HOUNDS WILL BE HAND SLIPPED AT THE START.

Irish Wolfhound Club of Canada IW Only Race Meet September 27, 2020

Large Gazehound Racing Association

Pre-entry fee: \$20 per hound
First Time Entered: \$2.00
glenamadda@gmail.com

For hounds with LGRA Number – Quick Entry

Breed: Irish Wolfhound Call Name: _____

LGRA Number: _____ First Time Entered? _____

Date Whelped: _____ Sex: Dog or Bitch

Indicate if: Canadian Conformation Champion. Yes/No
 Canadian Lure Coursing Champion Yes/No
 Veteran (Over 5 years) Yes/No

Breed: Irish Wolfhound Call Name: _____

LGRA Number: _____ First Time Entered? _____

Date Whelped: _____ Sex: Dog or Bitch

Indicate if: Canadian Conformation Champion. Yes/No
 Canadian Lure Coursing Champion Yes/No
 Veteran (Over 5 years) Yes/No

For First Time Entered Hounds with NO LGRA Number

Breed: Irish Wolfhound Call Name: _____

Registered Name: _____

Date Whelped: _____ Sex: Dog or Bitch

First Time Entered? YES **(Please include copy of registration- either AKC or CKC)**

Indicate if: Canadian Conformation Champion. Yes/No
 Canadian Lure Coursing Champion Yes/No
 Veteran (Over 5 years) Yes/No

Name of Owner: _____

Address: _____ Postal Code/Zip Code: _____

I and my heirs, legal representatives and assigns, shall hold harmless and defend the IWCC, its officers, directors, and agents, from a claim for personal injury, illness or property damage arising out of participation in this event. I agree to abide by the rules and regulations of the Large Gazehound Racing Association and its code of conduct during this race meeting.

Signature of Owner: _____

Telephone: _____

E-mail Address: _____

AWARDS & TROPHIES

Trophies and Ribbons will be awarded at this LGRA Race Meet for the following placements:

High Score
High Score Opposite Sex
Top Five Racers
High Score First Time Entered
High Score Veteran (5 yrs +)
Turtle Award
Ribbons for all placements

Donations still needed and gratefully accepted. If you would like to contribute please include the donation with your entry payment to the Race Secretary.

Kincairn Farm (Casey and Victor Nesbitt)
3874 Old Second Road North
Elmvale, (Springwater), Ontario, L0L 1P0
(Fully fenced hay field)

Directions from Toronto:

HWY 400 to Exit 121 (To Midland/Penetanguishene)
Turn RIGHT /north onto HWY 93 until you are north of the town of ORR LAKE.
Turn LEFT at the traffic light of HWY 27 to the top of the hill. Turn Left onto Old Second Road North, Arrive at #3874, Destination on the RIGHT into the CASTLEKEEP Driveway.

Directions from the North

HWY11 south to Trans-Canada HWY/ON 12 N in Orillia. Take the ON -12 W exit. Turn left onto Vasey Rd/ HWY 23 and follow straight through the traffic light onto HWY 27. At top of the hill, Turn left onto Old Second Road North. Arrive at #3874, Destination on the RIGHT into the CASTLEKEEP Driveway.

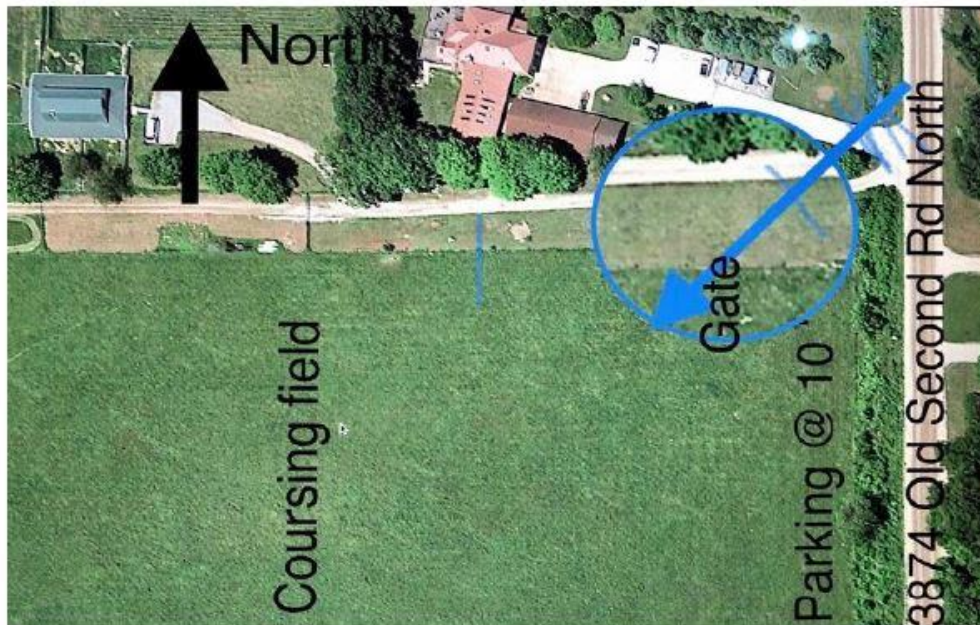

EXHIBITORS ARE ASKED TO KEEP SICK HOUNDS AT HOME.

COVID-19 EVENT WAIVER

I fully attest to the best of my knowledge that I do NOT have COVID19 at the time of attending this event. I also attest that I have NOT been in contact with or exposed to any known carrier of COVID-19 within the past 14 days. I agree that I am attending this LGRA event entirely at my own risk and take full responsibility for my own health and safety during this event. I will follow all LGRA and host club rules and requirements to reduce any exposure and possibility of contracting or spreading the virus. I will also fully cooperate with any city, county or state guidelines that have jurisdiction in the area in which the event is taking place.

I fully submit that the Large Gazehound Racing Assoc (LGRA), host club (Irish Wolfhound Club of Canada) and the property at Kincairn Farm - 3874 Old Second Rd North Elmvale (Springwater), Ontario L0L 1P0 that I am attending, and any workers or volunteers or judges, are in no way liable for any present or future COVID-19 exposure incurred at any time by any person, in attendance or not in attendance, during or after this event.

Print Name: _____

Signature: _____

Date: _____