

## ELIGIBILITY & COURSE

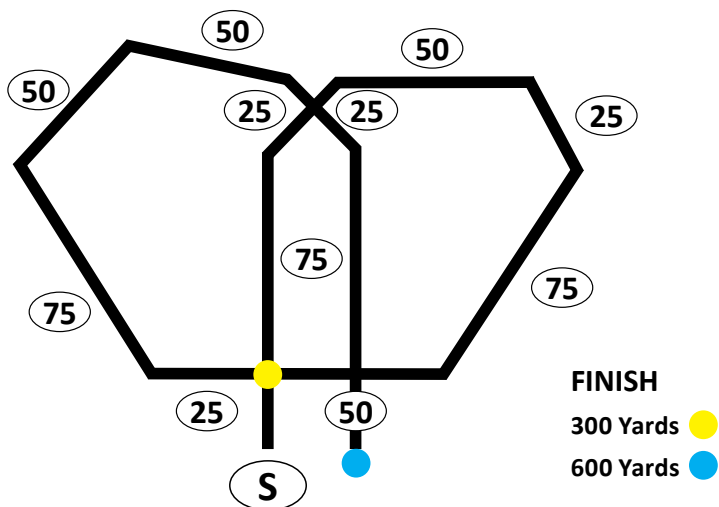

The field committee reserves the right to alter the course plan as required by weather and/or field conditions on the day of the event. (The direction will be reversed for the afternoon test.)

**ELIGIBLE BREEDS:** Chase Ability Program participation is open to all purebred and mixed-breed dogs at least 12 months of age that are individually registered with the CKC; or have an Event Registration Number (ERN); or have a Performance Event Number (PEN); or eligible for registration with the CKC; or have a Miscellaneous Certificate Number (MCN) if it belongs to a CKC listed breed; or have a Canine Companion Number (CCN) if it's a mixed breed.

Dogs with breed disqualifications are eligible to enter. Females in season may not enter. A dog may enter only once per event. Running order determined by order in which entries are received. Dogs run as singles.

**300-YARD COURSE:** This distance is for dogs shorter than 12 inches at the withers or brachycephalic ("flat-faced") dogs. **Dogs will run one loop.**

**600-YARD COURSE:** This distance is used for all dogs that do not run the 300 yard course. Dogs will run both loops.

If there is a question as to which course a dog will run, the judge will decide.

**RIBBONS:** Gold qualifying ribbons will be awarded to dogs passing their test.

**EXHIBITORS PLEASE NOTE:** It shall be the duty and obligation of the trial-giving club to see that a judge, club official, volunteer, or any participant at an event held under these rules is not subject to any indignities of any kind. The Field Trial Committee Chair shall promptly report to the CKC any infringement of this regulation, and the Discipline Committee shall have the authority to take such action as it deems fit on receipt of a report indicating that this has occurred.

OFFICIAL PREMIUM LIST



**SALUKI CLUB OF CANADA**

## 2 CKC CHASE ABILITY EVENTS SATURDAY, SEPTEMBER 30, 2017

TO BE HELD OUTDOORS, RAIN OR SHINE, AT  
Maple Lane Farm  
6311 12th Line, Alliston (New Tecumseth), ON L9R 1V4

### ROLL CALL

*Note: All dogs must be present for their appropriate roll-call time to be checked for lameness and bitches in season. Dogs will run in the order entries are received.*

**8:30 a.m.** Morning event

**11:30 p.m.** Afternoon event

### JUDGE

Saturday, September 30, 2017 – Both Events  
**Lisa Miceli**, 26859 Woodbine Ave., Keswick, ON L4P 3E9

### ENTRIES CLOSE:

**THURSDAY, SEPTEMBER 28, 2017, 8 PM (EST)**  
ENTRY LINE ENTRIES CLOSE SEPTEMBER 28, 2017, AT 4 PM (EST)

**THERE WILL BE NO DAY-OF-TRIAL ENTRIES**



Enter via The Entry Line

Mail entries to: Patty Milton  
5066 Wellington Rd. 125, Acton, ON L7J 2L9

Email entry form PDFs to: k94milton@gmail.com

Send payment (PayPal/E-transfers) to: scoctreasurer@gmail.com

*These events held under rules of the Canadian Kennel Club.*

**THERE WILL BE A LIMIT OF 50 ENTRIES ACCEPTED PER EVENT.**

## EXECUTIVE & TRIAL COMMITTEE

---

President .....	Debby Dillman
Vice-President .....	Robbie Pattison
Secretary/Treasurer.....	Patty Milton 5066 Wellington Rd. 125, Acton, ON L7J 2L9 k94milton@gmail.com
Past President.....	Dee Laurie-Beaumont
Directors .....	Wenche Overland, Julie Poirier, Melissa Williams, Priscilla McLeod, Robby Parish
Event Chair.....	Sherri Hall
Event Superintendent.....	Patty Milton
Event Secretary.....	Patty Milton 5066 Wellington Rd. 125, Acton, ON L7J 2L9 k94milton@gmail.com
Official Veterinarian.....	Veterinary Emergency Clinic 115 Bell Farm Rd., Unit 110, Barrie, ON L4M 5G1 Phone: 705-722-0377

## FIELD COMMITTEE

---

Inspection Committee.....	Patty Milton
Hunt Master.....	Janice Preiss
Lure Operator .....	Brad Heppel
Field Clerk .....	Branka Bradic
Paddock Master.....	Susie Konopa

## CANADIAN KENNEL CLUB OFFICERS

---

CKC Offices .....	Mr. Lance Novak 200 Ronson Dr., Ste. 400, Etobicoke, ON M9W 5Z9 (416) 675-5511   www.ckc.ca
CKC Director .....	Mr. Richard Paquette
Lure Coursing Rep .....	Eva Hunter

**Exhibitors Please Note:** It shall be the duty and obligation of the event-giving club to see that a judge, club official, volunteer, or any participant at an event held under these rules is not subject to any indignities of any kind. The Event Committee Chair shall promptly report to the CKC any infringement of this regulation, and the Discipline Committee shall have the authority to take such action as it deems fit on receipt of a report indicating that this has occurred.

## ENTRIES

---

Entry fee for Regular classes.....	\$20.00
Listing fee .....	\$ 9.50*

\*A listing fee of \$9.50 must accompany each entry for each dog per show and is payable with the entry fee if the entry form for the dog does not include its CKC individual registration number. **Dogs requiring a PEN or CCN number cannot be entered as a listed dog.**

### MAIL ENTRIES TO:

**Patty Milton, 5066 Wellington Rd. 125, Acton, ON L7J 2L9**  
Make cheques payable to "Saluki Club of Canada." Credit cards or postdated cheques will not be accepted.

### EMAIL ENTRIES:

Entries can be sent electronically to k94milton@gmail.com  
Payment can be made via PayPal or e-transfers to scoctreasurer@gmail.com.



### ENTER VIA THE ENTRY LINE:

1-800-293-2935 | Fax: (519) 754-0796 | www.theentryline.com

Mastercard Visa American Express

**ENTRIES TAKEN UNTIL 4 P.M. ON THE DAY OF CLOSING.**

This is a privately owned business that charges a fee for their service.

***Entries will be acknowledged by e-mail if a legible e-mail address is provided.  
No other acknowledgements will be sent.***

### ENTRY INFORMATION:

1. No entry will be accepted unless the entry form is completed in full and accompanied by a signed waiver and entry fees. Telephone entries cannot be accepted.
2. Cheques dated after the close of entries will not be accepted. Tendering of an NSF cheque will be considered non-payment of entry fees and can result in the cancellation of awards. All NSF/returned cheques will be assessed a \$30 service charge. There will be no refund of overpayments or duplicate entries.
3. An exhibitor has the right to withdraw an entry up to the closing date and time as published in the premium list. Written or electronic notification must be received by the Event Secretary by the official closing date and time. If written notification is not received by that time, the dog will remain entered in the event. Entries that are cancelled before the closing date will be refunded.

### GENERAL INFORMATION:

1. The Trial Superintendent will be in full charge of the trial, which will be governed by CKC rules.
2. If, because of riot, civil disturbance, or other acts beyond the control of management, it is impossible to open or complete the trials, no refund of Entry Fees will be made.

**THERE WILL BE A LIMIT OF 50 ENTRIES PER EVENT.**



# SALUKI CLUB OF CANADA WAIVER

## RELEASE OF LIABILITY, WAIVER OF CLAIMS, ASSUMPTION OF RISK AND INDEMNITY AGREEMENT

By signing this document you will waive certain legal rights, including the right to sue or claim compensation following an accident. Please read this document carefully.

I \_\_\_\_\_ [print name] certify that I am the actual owner of this/these dog(s) \_\_\_\_\_ [print name of dog(s)] or that I am the duly authorized agent of the actual owner whose name I have entered above.

In consideration of acceptance of the entry and the opportunity to have the dog judged and to win ribbons or prizes at the Chase Ability events to be held on September 30, 2017, I agree:

1. To hold the Saluki club of Canada including its members, directors, officers and employees (collectively defined as the "SCOC"), as well as the owner and lessor of the real property on which the event is held, harmless from any claim for loss or injury which may be alleged to have been caused directly or indirectly to any person or thing by the act of myself or my dog(s) while in or about the event premises or grounds near the entrance thereto and I assume all responsibility and liability for any such claim;
2. To hold the SCOC harmless from any claim for loss of this dog by disappearance, theft, death or otherwise and from any claim for damage or injury, even if such loss or damage/injury was caused or alleged to be caused by negligence of the SCOC or any other person(s);
3. To assume the sole responsibility for and agree to indemnify, defend and save the SCOC harmless from any and all loss and expense, including legal fees, by reason of the liability imposed by law upon the SCOC for damage because of bodily injuries, including death at any time resulting therefrom, sustained by any person(s), including myself, or on account of damage to property, arising out of or in consequence of my participation in the event, however such injuries, death or property damage may be caused and whether or not the same may have been caused or may be alleged to have been caused by the negligence of the SCOC or any other person(s);
4. That any cause of action, controversy or claim arising out of or related to the attendance at the event between the SCOC and myself or as to the construction, interpretation and effect of this waiver shall be settled by arbitration in the province of Ontario and
5. That the SCOC has the right to refuse this entry for cause, which the SCOC will deem sufficient.

\_\_\_\_\_  
Signature

\_\_\_\_\_  
Date

**THIS WAIVER MUST ACCOMPANY YOUR ENTRIES OR THEY WILL NOT BE ACCEPTED.**



OFFICIAL CANADIAN KENNEL CLUB FORM

CHASE ABILITY

**SALUKI CLUB OF CANADA**

SATURDAY, SEPTEMBER 30, 2017 – TWO LIMITED-ENTRY EVENTS

**PLEASE NOTE: THE WAIVER IN THIS PREMIUM LIST MUST ACCOMPANY YOUR ENTRIES OR THEY WILL NOT BE ACCEPTED.**

ENTRY FEES \$ \_\_\_\_\_ LISTING FEES \$ \_\_\_\_\_ TOTAL \$ \_\_\_\_\_

DATES:

Saturday, September 30, 2017, Morning

Saturday, September 30, 2017, Afternoon

CLASSES:

Dogs 12" and Shorter and/or Brachycephalic Dogs

Dogs Over 12"

Reg. Name of Dog \_\_\_\_\_

Call Name \_\_\_\_\_ Breed \_\_\_\_\_  Male  Female

CKC Reg. No. \_\_\_\_\_ DOB: D \_\_\_\_\_ M \_\_\_\_\_ Y \_\_\_\_\_

CKC ERN/PEN No. \_\_\_\_\_ Place of Birth

CKC Misc. Cert. No. \_\_\_\_\_  Canada  Elsewhere

CKCCCN No. \_\_\_\_\_  Listed *Not applicable to PEN or CCN dogs*

Breeder(s) \_\_\_\_\_

Sire \_\_\_\_\_

Dam \_\_\_\_\_

Reg'd Owner(s) \_\_\_\_\_ CKC Member No. \_\_\_\_\_

Owner's Address \_\_\_\_\_

City \_\_\_\_\_ Prov. \_\_\_\_\_ Postal Code \_\_\_\_\_

I CERTIFY that I am the registered owner(s) of the dog or that I am the authorized agent of the owner(s) whose name(s) I have entered above and accept full responsibility for all statements made in this entry. In consideration of the acceptance of this entry, I (we) agree to be bound by the rules and regulations of the Canadian Kennel Club and by any additional rules and regulations appearing in the premium list.

\_\_\_\_\_  
OWNER SIGNATURE

\_\_\_\_\_  
PHONE NUMBER

\_\_\_\_\_  
EMAIL ADDRESS

*EXHIBITORS: DON'T FORGET TO INCLUDE YOUR PHONE NUMBER AND EMAIL ADDRESS. THANK YOU!*

## CANADIAN KENNEL CLUB INFORMATION

### NOT A CKC MEMBER?

In order for the title to be awarded, the non-member will have a choice to either become a CKC member or pay the Non-Member Participation Fee. Failure to comply within 30 days of notification will result in the title being withheld and the dog cannot be moved up to the next level.

A Non-Member Participation Fee will be charged to a resident of Canada who is a non-member of the CKC. The fee will be \$59.40, plus applicable taxes. The fee applies only to dogs wholly owned by non-member residents of Canada and is not applicable to CKC members (or dogs co-owned by CKC members).

The Non-Member Participation Fee is paid in any year a title is earned and covers all titles and dogs owned by that individual.

### HAVE A MIXED BREED OR A BREED NOT RECOGNIZED BY THE CKC?

**These events are open to mixed and unrecognized breeds.** In order to compete, mixed and unrecognized breed dogs **must have a CANINE COMPANION NUMBER (CCN)** from the Canadian Kennel Club. Mixed-breed dogs must be spayed or neutered. Unrecognized-breed dogs do not need to be spayed or neutered. A dog eligible for a CCN may not be entered as a listed dog.

### EVENT REGISTRATION NUMBER *(For a foreign-owned, registered dog)*

All dogs that are foreign born and foreign owned and enter Canada for the sole purpose of entering CKC events will no longer require a CKC registration number but will require an Event Registration Number (ERN). This ERN does not register a dog for breeding purposes as defined in the Animal Pedigree Act, but rather enables a foreign-owned dog to be awarded titles by the Canadian Kennel Club. Each dog must have its own number.

AN ERN MUST BE APPLIED FOR WITHIN 30 DAYS OF FIRST DAY OF ENTERING A CKC EVENT TO AVOID CANCELLATION OF AWARDS.

### PERFORMANCE EVENT NUMBER *(Required for an unregistrable purebred dog)*

A Performance Event Number (PEN) allows an unregistrable dog of a CKC recognized of listed breed to participate in competitive events that are appropriate for the breed. A PEN dog must meet the following criteria: be of a CKC recognized or listed breed; for one reason or another, must not be eligible for CKC registration; and must be spayed or neutered.

*Event rulebooks and application forms for the Non-Member Participation Fee, ERN, PEN and CCN are available on the CKC website. For more information, contact:*

#### THE CANADIAN KENNEL CLUB

Phone: (416) 675-5511 | Fax: (416) 675-6506  
Email: [information@ckc.ca](mailto:information@ckc.ca) | Website: [www.ckc.ca](http://www.ckc.ca)  
Hours: 9 a.m. to 5 p.m. (Monday - Friday)

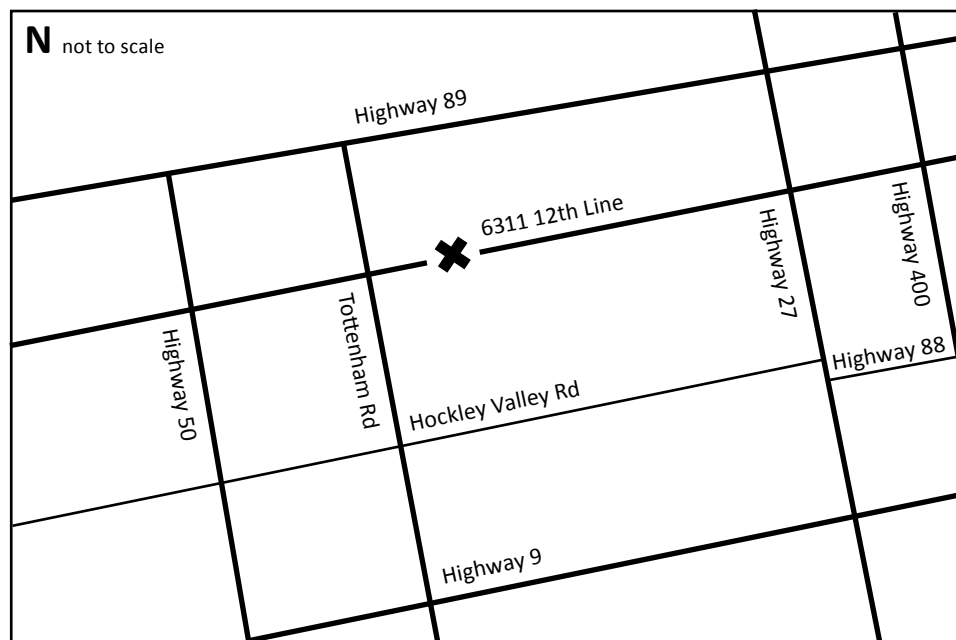

DIRECTIONS FROM HWY 400: Exit 64 at Hwy 88. Go West towards Bond Head. Turn right on Hwy 27. Left on Simcoe Country Rd. #1 towards Beeton; the first traffic light is Patterson St. Turn right on Patterson; go north to the 12th Line. Turn left (west) on the #6311 is on the left.

## ADDITIONAL INFORMATION

- Port-a-potty on site.
- Dogs will be run once.
- Lame dogs or bitches in season will be excused and their entry refunded, provided notice is given prior to or during roll call.
- Dogs not present at roll call shall be scratched with no refunds. No Exceptions.
- Dogs are expected to be aroused and excited in the presence of the lure, but handlers must be able to control their dogs for everyone's safety or they shall be refunded their entry and not allowed to run. Additionally, the field committee reserves the right to bar known aggressive dogs from the event site.
- Muzzles and catch collars may be used at the handler's discretion. **No Flexi-leads, or prong or electronic collars allowed.**
- A \$10 fine will be assessed for loose dogs on the field after roll call and until after the last test.
- Bring your own water and shade.
- Please clean up after yourselves and your dogs. Do not stuff plastic bags down holes. Please use the trash receptacles provided.

## LUNCH

Lunch will be offered by pre-order. \$10 per person. Watch the "Lurecoursing at Maplelane Farms" Facebook page for menu details or contact Alison Preiss at [alison.preiss@gmail.com](mailto:alison.preiss@gmail.com).

*Cash payment for lunch can be paid on the day.*